

433 MHZ REMOTE THERMO

INTRODUCTION:

Congratulations on purchasing this innovative 433MHz Remote Thermo which displays indoor and up to three outdoor temperature readings. To enjoy the full benefits of this innovative product, please read this operating manual.

REMOTE THERMO:

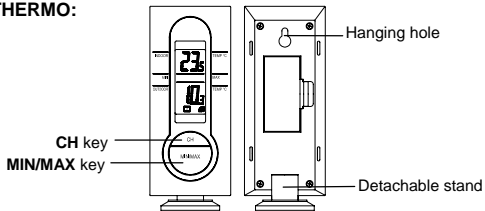

TEMPERATURE TRANSMITTER:

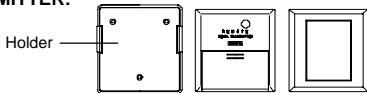

FEATURES:

- Temperature display in degrees Celsius
- Indoor temperature display
- Outdoor temperature display
- MIN/MAX indoor and outdoor temperature display
- Can receive up to three outdoor transmitters
- Table standing or wall mountable (detachable table stand)

SETTING UP:

Please follow these steps to ensure that your new Remote Thermo works correctly with the temperature transmitter(s):

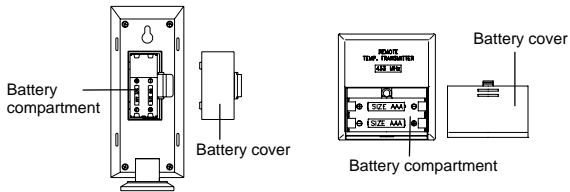

1. Flip open the battery cover at the back of the Remote Thermo as indicated above.
2. Checking the correct polarization, insert 2 x AAA, IEC LR3, 1.5V batteries into the battery compartment and replace the cover (all the segments of the LCD screen will light up momentarily).
3. Now slide the battery cover open on the transmitter as indicated above

4. Checking the correct polarization, insert 2 x AAA, IEC LR3, 1.5V batteries into the battery compartment and replace the cover.
5. If you have purchased additional outdoor transmitter(s) wait until the outdoor temperature has been received from the one transmitter before activating the next transmitter by repeating steps 3 and 4.
6. However, ensure that you leave 10 seconds in between the reception of the last transmitter and the set-up of the following transmitter. The Remote Thermo will number the transmitters in the order of set-up, i.e. the first transmitter will have the temperature displayed with the number 1 against it and so on.
7. When the outdoor temperature(s) is received the Remote Thermo and transmitter(s) should be positioned in the desired places (see **Positioning & securing** below)

Note:

Should the total time of inserting the batteries into the transmitters take longer than 2-1/2 minutes from the time of inserting the batteries into the Remote Thermo then temperature reception problems may occur. If the temperature is not received, then see **Checking for 433 MHz reception**, before resetting the units (see **Resetting the Remote Thermo** below).

In the event of changing batteries in any of the units, all units need to be reset by following the setting up procedures. This is because a random security code is assigned by the transmitter at start-up and this code must be received and stored by the Remote Thermo in the first 2-1/2 minutes of power being supplied to it.

LCD SCREEN

The Remote Thermo's LCD is comprised of three lines and once the batteries are inserted, all the segments will light up momentarily before displaying:

1. Indoor temperature in degree Celsius ($^{\circ}\text{C}$)
2. Outdoor temperature in degree Celsius ($^{\circ}\text{C}$)

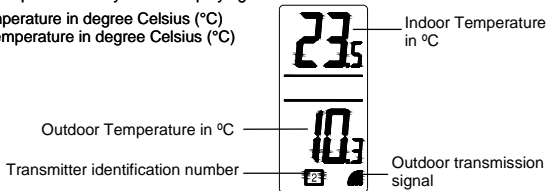

USING THE REMOTE THERMO:

INDOOR TEMPERATURE:

The indoor temperature is displayed on the first line of the LCD. The Remote Thermo's built in sensor automatically measures the temperature once the batteries are inserted.

OUTDOOR TEMPERATURE READING:

The outdoor temperature is displayed on the bottom line of the LCD. The Remote Thermo receives the outdoor temperature via 433MHz frequency when the batteries are inserted into the transmitter within the 2-1/2 minutes of the setting up time (See **Setting up** above).

Note: Should the outdoor temperature not be received within 2-1/2 minutes after inserting the batteries into a transmitter, then see "**Checking 433 MHz reception**" below.

MINIMUM AND MAXIMUM INDOOR AND OUTDDOR TEMPERATURE RECORDINGS:

To view the minimum or maximum indoor and/or outdoor temperature, press the "**MIN/MAX**" key to view:

1. MIN indoor temperature
2. MAX indoor temperature
3. MIN outdoor temperature
4. MAX outdoor temperature
5. To return to current indoor and outdoor temperature display

Remarque:

Once a new indoor temperature high or low is reached, it will automatically set into the Remote Thermo's memory.

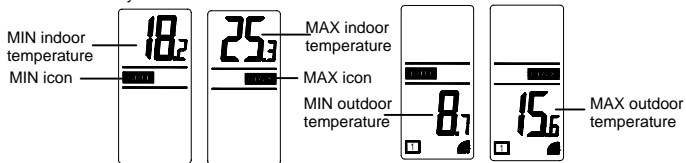

RESETTING THE MINIMUM AND MAXIMUM TEMPERATURE RECORDING:

TO RESET THE MIN OR/AND MAX INDOOR TEMPERATURE RECORDS:

1. Press the **“MIN/MAX”** key to select the indoor MIN or MAX records.
2. Press and hold the **“CH”** key for 3 seconds. **Both the MIN and MAX records will be reset to current indoor temperature.**

TO RESET THE MIN OR/AND MAX OUTDOOR TEMPERATURE RECORDS:

1. First selected the transmitter to reset by pressing the **“CH”** key if more than one transmitter is used. **There is no transmitter number displayed if only one transmitter is used.**
2. Press the **“MIN/MAX”** key to select the outdoor MIN or MAX records.
3. Press and hold the **“CH”** key for 3 seconds. **Both the MIN and MAX records will be reset to current outdoor temperature.**

Note: If more than one transmitter is used, repeat the same steps above for each transmitter.

OUTDOOR TEMPERATURE 1, 2, AND 3

If the more than one transmitter is being used, to alternate between the temperature readings of transmitter 1, 2, and 3, simply press the “CH” key. If the reading is from transmitter 1, then the identification numbers 1 will be displayed in the outdoor temperature section of the LCD. The same will apply to the next transmitter and so on. However, if only one transmitter is used, no identification number will be displayed on the LCD.

CHECKING FOR 433 MHz RECEPTION:

In normal surroundings (for example away from interfering sources such as TV sets), the outdoor temperature can usually be easily received within 2-1/2 minutes. If the outdoor temperature is not displayed on the LCD after 2-1/2 minutes, then check the following:

1. The distance of the units should be at least 1.5 - 2.0 meters away from interfering sources such as computer monitors or TV sets.
2. Avoid placing the units onto or in the immediate proximity of metal doors, window frames or structures.
3. Using other electrical products such as headphones and speakers that operate on the same signal (433 MHz) can prevent the transmission pick up.

4. Neighbours using electrical products operating on the 433MHz signal can also cause interference. In most severe cases, the reception is only possible once all other electrical products using the 433MHz are switched off.
5. Within thick concrete rooms such as basements and tower blocks, the 433MHz signal can be weakened (avoid placing near metal frames and structures).
6. Transmission can be affected by exposure to extreme temperature conditions. For example, if the weather has been extremely cold (under -25°C) for an extended period of time then the transmission signal may be weakened. (Please bears this in mind when positioning the transmitter).

Note: Should after checking the above list and the outdoor temperature is still not received, then reset the units (see **Resetting the Remote Thermo** below).

RESETTING THE REMOTE THERMO:

1. Remove the batteries from the Remote Thermo and the transmitter(s)
2. Wait at least 30 seconds and repeat the procedures specified in **Setting up** above.

Note: Remember when resetting, all units have to be reset and to always insert the batteries into the Remote Thermo first and then followed by the transmitter(s).

POSITIONING

REMOTE THERMO:

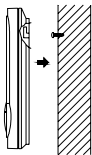

The Remote Thermo comes complete with a detachable stand that gives the option of table standing or wall mounting. To wall mount:

1. Fix a screw into the desired wall, leaving the head extended out the by about 5mm.
2. Using the Remote Thermo's hanging hole, carefully hang it onto the screw.

Note: Always ensures that the unit locks onto the screw head before releasing.

OUTDOOR TRANSMITTER:

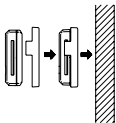

The Outdoor Transmitter is supplied with a holder that may be attached to a wall with the three screws or double-sided tape supplied. To attach to the wall using screws, please follow the steps below:

1. Mark the wall using a pen through the holes in the holder to obtain the exact drilling position.
2. Drill holes in the wall at the points marked.
3. Screw holder onto wall.

The Outdoor Transmitter simply clicks in or out of the holder. When inserting or removing the Outdoor Transmitter to or from the wall holder please hold both units securely to avoid tearing the holder from the wall.

There is also double sided tape included with the wall holder. On smooth surfaces this can be used instead of drilling holes. The mounting surface can, however, affect the transmission range. If for example the unit is attached to a piece of metal, it may then either reduce or increase the transmitting range. For this reason, we recommend not placing the unit on any metal surfaces or

in any position where a large metal or highly polished surface is in the immediate proximity (garage doors, double-glazing, etc.). Before securing in place, please ensure that the Remote Thermo can receive the 433 MHz signal from the Outdoor Transmitter at the positions that you wish to situate them.

BATTERIES REPLACEMENT & MAINTENANCE:

For best performance, batteries to all units should be replaced at least once a year to maintain optimum running accuracy. Ensure that the batteries used are new of the correct size.



Please help in the preservation of the environment and return used batteries to an authorized depot.

CARE AND MAINTENANCE:

- Avoid placing the units in areas prone to vibration and shock as these may cause damage.
- Avoid areas where the units can be exposed to sudden changes in temperature, i.e. direct sunlight, extreme cold and wet/moist conditions as these will lead to rapid changes in temperature which reduces the accuracy of readings.

- When cleaning the LCD and casing, use a soft damp cloth only. Do not use solvents or scouring agents.
- Do not submerge the units into water.
- Immediately remove all low powered batteries to avoid leakage and damage. Replace only with new batteries of the recommended size.
- Do not make any repairs to the units. Please return them to the original point of purchase for repair by a qualified engineer. Opening and tampering with the units may invalidate its guarantee.

SPECIFICATIONS:

- Temperature measuring range
 - Indoor : 0°C to +60°C with 0.1°C resolution
("OF.L" displayed if outside this range)
 - Outdoor : -29.9°C to +69.9°C with 0.1°C resolution
("oF.L" displayed if outside this range)

- Temperature checking intervals
 - Indoor temperature : every 10 seconds
- Transmitter : every 1 minutes
- Transmitting frequency : 433.92 MHz
- Temperature transmitting : range up to 25 meters
(Open space and free from interference)
- Power source:
 - Remote Thermo : 2 x AAA, IEC LR3, 1.5V batteries
 - Transmitter : 2 x AAA, IEC LR3, 1.5V batteries
- Battery life for both units : Approximately 12 months
(Alkaline batteries recommended)
- Dimensions (L x W x H):
 - Remote Thermo : 55 x 23 x 130 mm (without stand)
 - Transmitter : 59 x 22 x 65 mm (without wall mount)

LIABILITY DISCLAIMER:

- The manufacturer and supplier cannot accept any responsibility for any incorrect readings and any consequences that occur should an inaccurate reading take place.
- This product is designed for use in the home only as indication of the temperature.
- This product is not to be used for medical purposes or for public information.
- The specifications of this product may change without prior notice.
- This product is not a toy. Keep out of the reach of children.
- No part of this manual may be reproduced without written authorization of the manufacturer.

R&TTE Directive 1999/5/EC

Summary of the Declaration of Conformity : We hereby declare that this wireless transmission device does comply with the essential requirements of R&TTE Directive 1999/5/EC.